

Fuji USER MANUAL

ANGLE GRINDERS

MODELS : FA-4C-1, -1F



FA-4C-1

FA-4C-1F

SPECIFICATIONS

Model	Max.Dia (Grinding Wheel)		Rotational Frequency min ⁻¹	Spindle Thread Size	Angle Head Height		Overall Length		Mass		Max. Air Consumption		Air Inlet Thread Size	Air Hose Size	
	mm	in			mm	in	mm	in	kg	lb	m ³ /min	ft ³ /min		mm	in
FA-4C-1	100×6×15.8	4×1/4×5/8	13,500	M8-P1.25 (F)	77	3 1/32	210	8 17/64	1.8	3.9	0.55	19.4	Rcor NPT 3/8	9.5	3/8
FA-4C-1F	100×6×15.8	4×1/4×5/8	13,500	M8-P1.25 (F)	77	3 1/32	266	10 15/32	1.8	3.9	0.55	19.4	Rcor NPT 3/8	9.5	3/8

The performance figures are at 0.63MPa (6.3bar).

⚠ Refer to "The Instructions and Warning for Safety Use" enclosed in each tool box.

Fuji Industrial Technique Co.,Ltd.

2-1-14, Kamiji, Higashinari-ku, Osaka, 537-0003 Japan

Tel : 81-6-6972-2335

Fax : 81-6-6972-2380

MODELS : FA-4C-1, -1F

EXPLODED VIEW

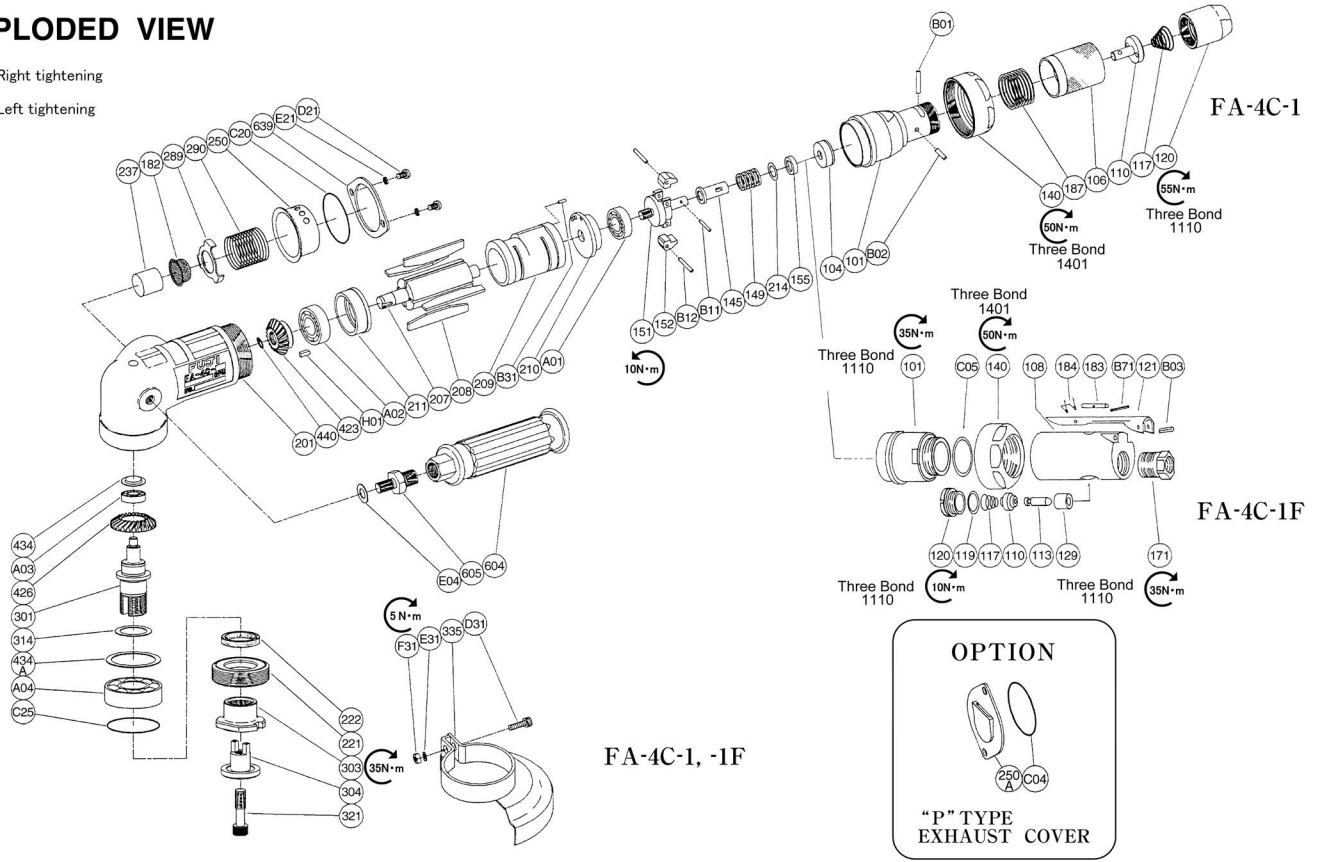

PARTS LIST

Index No.	Parts No.	Parts Name	Qty	Index No.	Parts No.	Parts Name	Qty	Index No.	Parts No.	Parts Name	Qty
FA-4C-1											
—	G-101001-00	Housing Cover Ass'y (Rc)		183	G-144183-02	Lock Key	1	303	A-093303-02	Wheel Flange (A)	1
—	G-101001-01	Housing Cover Ass'y (NPT)		184	G-144184-00	Lock Spring	1	304	A-093304-01	Wheel Flange (B) (5/8")	1
101	G-101001-50	Housing Cover	1	B71	SP-218	Spring Pin	1	314	A-109314-00	Wheel Spindle Washer (T=0.5)	1
(104)	G-101104-00	Bushing	1	FA-4C-1, -1F							
106	G-042106-04	Throttle Valve Handle	1	—	A-107010-00	Governor Weight Ass'y		A-109314-01	Wheel Spindle Washer (T=0.3)	1	
110	G-042110-00	Throttle Valve	1	151	A-107151-01	Governor Cage	1	A-109314-02	Wheel Spindle Washer (T=0.2)	1	
117	G-042117-00	Throttle Valve Spring	1	152	A-010152-00	Governor Weight	2	A-021321-01	Detent Bolt	1	
120	G-042120-00	Throttle Valve Cover (Rc)	1	B12	GP-2.516GCH	Grooved Pin	2	A-107335-00	Wheel Guard	1	
	G-042120-F	Throttle Valve Cover (NPT)	1	—	A-107012-00	Exhaust Cover Ass'y		(D31)	HS-625	Hexagon Bolt	1
187	G-042187-00	Throttle Valve Handle Spring	1	182	W-065182-00	Strainer	1	(E31)	SW-6	Spring Washer	1
B01	NR-316.8	Needle Roller	1	237	A-094237-00	Muffler Pad	1	(F31)	N-6	Nut	1
B02	NR-39.8	Needle Roller	1	250	A-107250-00	Exhaust Cover	1	423	A-107423-00	Bevel Pinion	1
FA-4C-1F											
LOCKING HANDLE LEVER TYPE											
—	A-107001-00	Housing Cover Ass'y (Rc)		250	A-107250-00	Exhaust Cover	1	426	A-093426-02	Bevel Gear	1
—	A-107001-01	Housing Cover Ass'y (NPT)		289	A-107289-00	Muffler Plate	1	434	A-021434-00	Bearing Washer	1
101	G-161101-00	Housing Cover	1	290	A-107290-00	Muffler Spring	1	434A	A-093434-00	Bearing Washer	1
140	G-101140-00	Cup Nut	1	C20	O-S40	"O" Ring	1	440	A-107440-00	Ring	1
C05	O-S26	"O" Ring	1	140	G-101140-00	Cup Nut (for FA-4C-1)	1	604	A-025604-02	Dead Handle	1
—	A-107003-00	Throttle Valve Body Ass'y (Rc)		145	A-065145-00	Governor Valve	1	605	A-107605-00	Dead Handle Joint	1
—	A-107003-01	Throttle Valve Body Ass'y (NPT)		149	A-093149-01	Governor Valve Spring	1	639	A-107639-00	Exhaust Cover Holder	1
108	A-107003-50	Throttle Valve Body	1	155	A-065155-00	Governor Valve Spring Holder	1	A01	BB-609MN	Ball Bearing	1
(129)	H-014129-00	Throttle Valve Rod Bushing	1	201	A-107201-00	Housing	1	A02	BB-6200	Ball Bearing	1
110	H-001110-02	Throttle Valve	1	207	A-107207-00	Rotor	1	A03	BB-626	Ball Bearing	1
113	G-028113-00	Throttle Valve Rod	1	208	G-103208-00	Rotor Blade	4	A04	BB-6004ZZ	Ball Bearing	1
117	D-001117-00	Throttle Valve Spring	1	209	G-161209-00	Cylinder	1	B11	NR-211.8	Needle Roller	1
119	G-028119-00	T.V. Cover Packing	1	(B31)	SP-26	Spring Pin	1	C25	O-S40	"O" Ring	1
120	G-028120-00	Throttle Valve Cover	1	210	A-107210-00	Cylinder Upper Plate	1	D21	CS-510B	Cap Screw	2
171	IB-4030S0	Inlet Bushing (Rc)	1	211	A-107211-00	Cylinder Lower Plate	1	E04	PW-8	Plain Washer	1
	IB-403NS0	Inlet Bushing (NPT)	1	214	A-065214-00	Adjusting Washer (T=0.2)	1	E21	SW-5	Spring Washer	2
B03	SP-320	Spring Pin	1		A-065214-01	Adjusting Washer (T=0.3)	1	H01	K-338F	Key	1
					A-065214-02	Adjusting Washer (T=0.5)	1	OPTIONAL PART			
—	G-144019-01	Lock Lever Ass'y		221	A-107221-00	Spindle Bearing Cover	1	"P" TYPE EXHAUST COVER			
121	G-144121-02	Throttle Valve Lever	1	222	A-021222-00	Felt Ring	1	250A	A-107250-01	Exhaust Cover	1
				301	A-093301-01	Wheel Spindle	1	C04	O-P38	"O" Ring	1

■ Standard Accessories

AC No.	Description	Qty
F-706	6mm Hex. Pin Wrench	1
F-112	32mm Open-End Wrench	1

- The related parts are shown in thick frame.
- #101, #108, #209 and #335 are supplied together with parts shown in ().
- Specify parts number and quantity when ordering.